

Accelerator Pedal

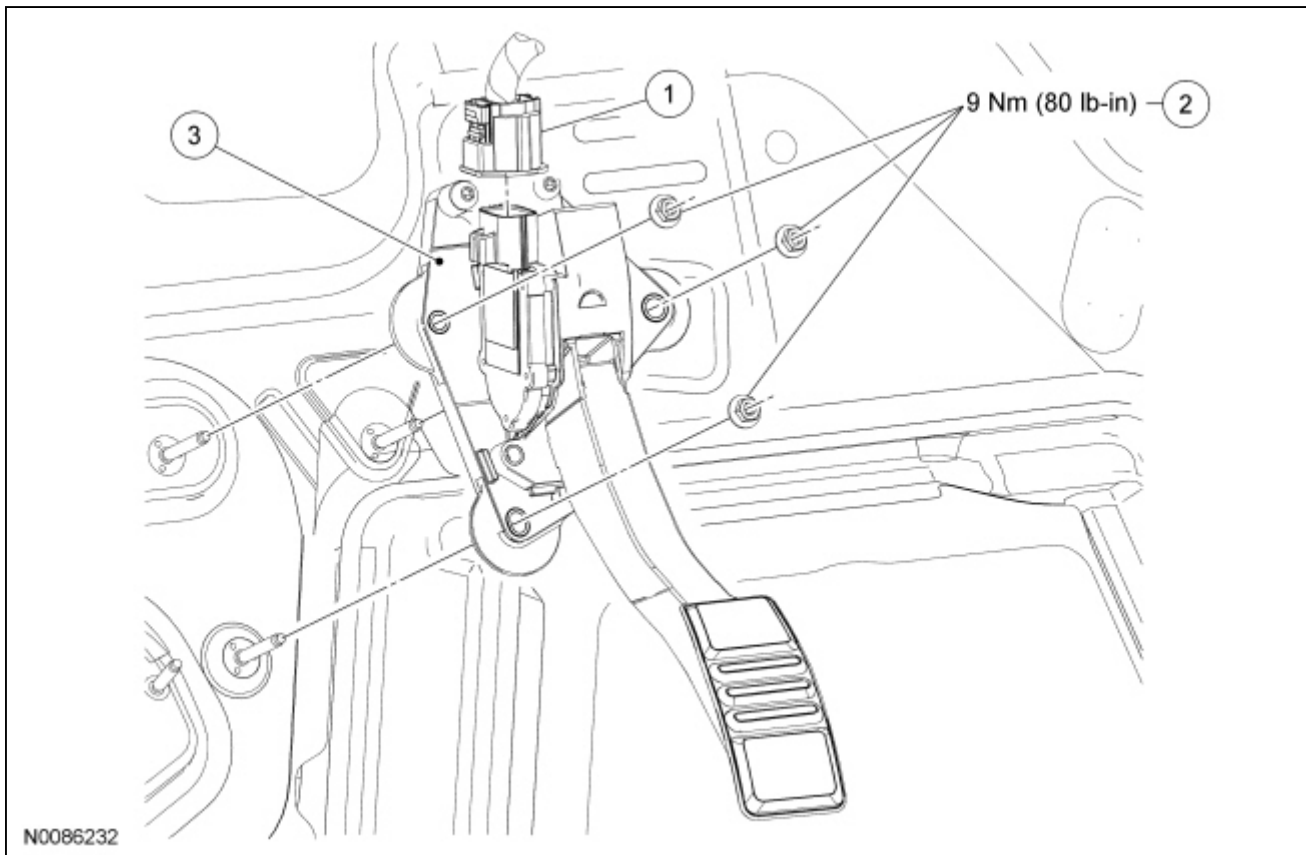

Item	Part Number	Description
1	14A464	Accelerator pedal sensor electrical connector
2	W711330	Accelerator pedal and sensor nuts (3 required)
3	9F836	Accelerator pedal and sensor assembly

Removal and Installation

1. Disconnect the accelerator pedal sensor electrical connector.
 - During installation, make sure that the red lock tab on the electrical connector is fully engaged to make sure of a complete connection.
2. Remove the 3 nuts and the accelerator pedal and sensor.
 - To install, tighten to 9 Nm (80 lb-in).
3. To install, reverse the removal procedure.

